

Sliding door hardware  
for grooved wood doors  
up to 176 lb (80 kg)

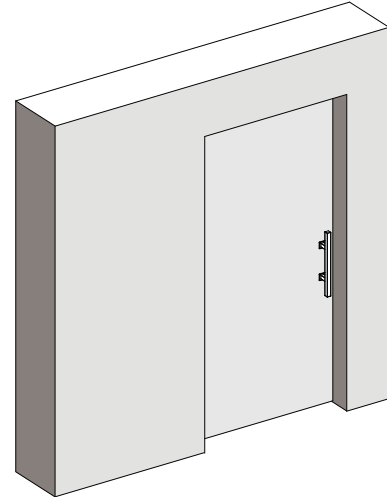

**i**

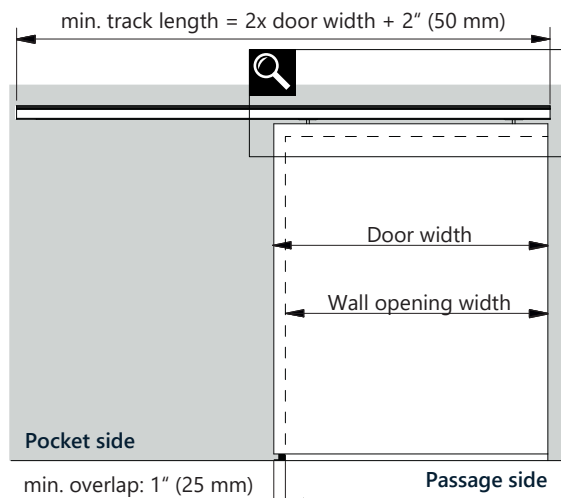
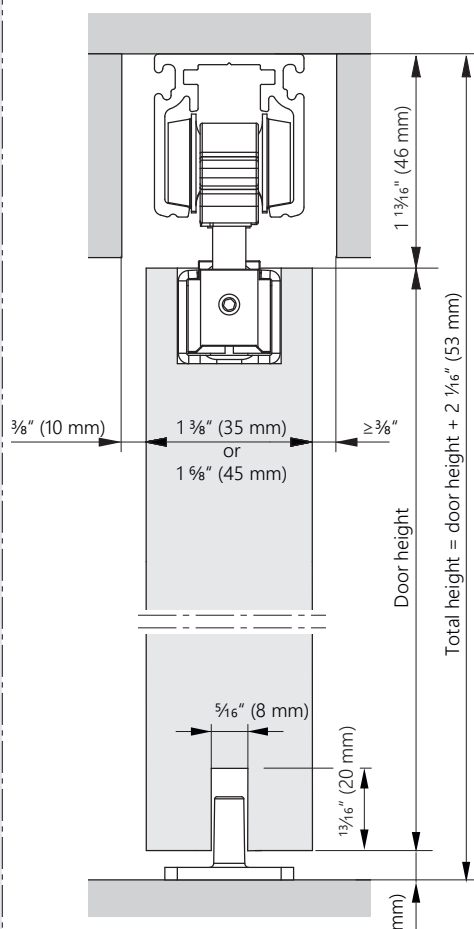

When installing a double door, please follow the instructions provided separately.

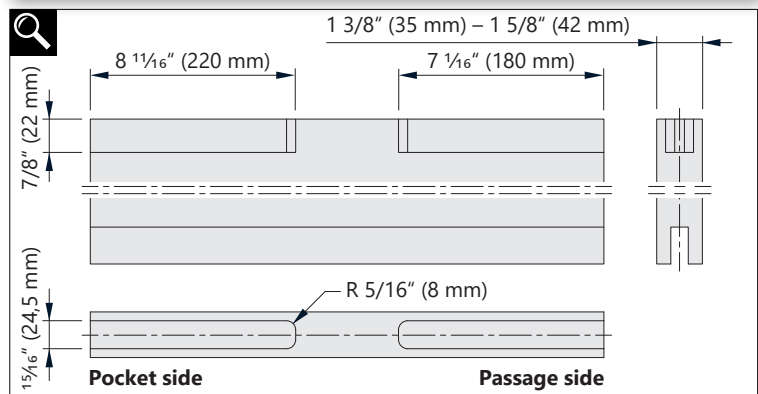

**i Content**

1x

**a**

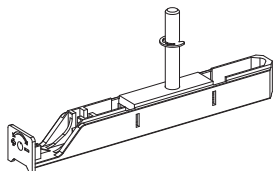

1x

**b**

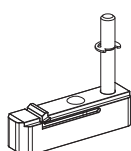

2x

**c**

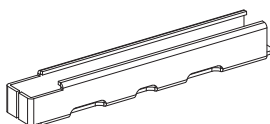

2x

**d**

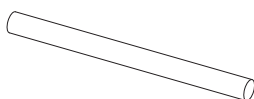

1x

**e**

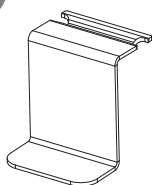

**1**

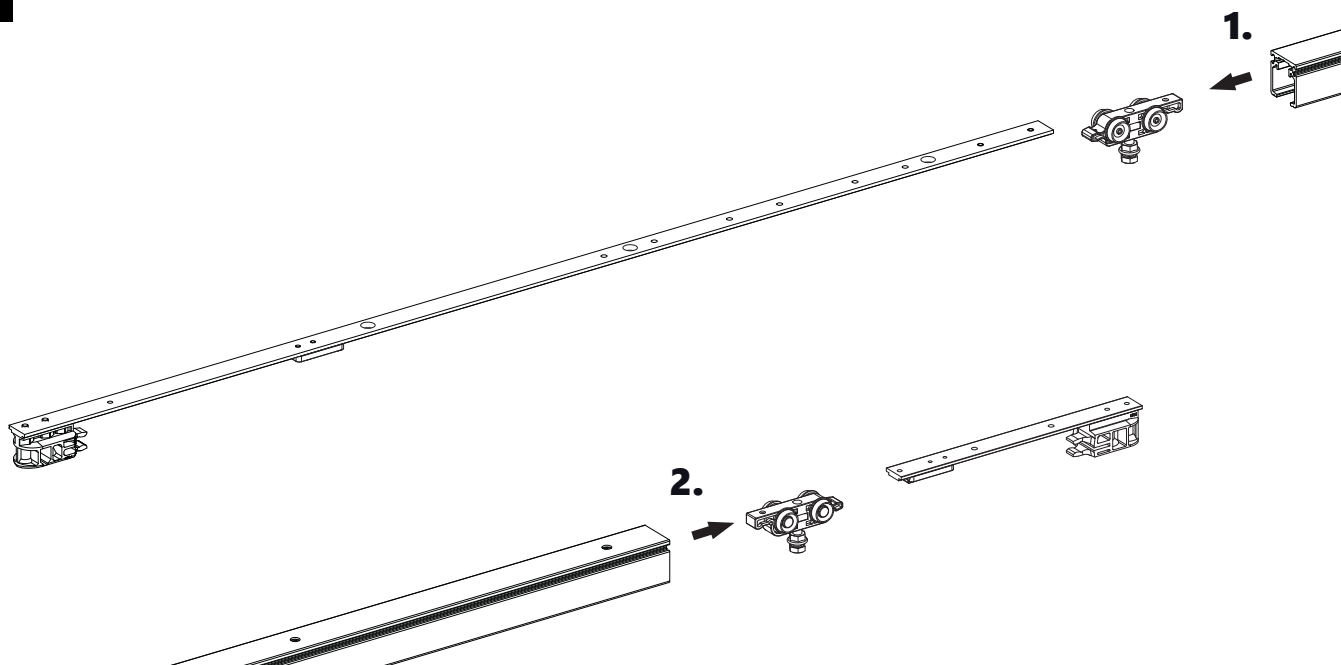

**2** Version 1

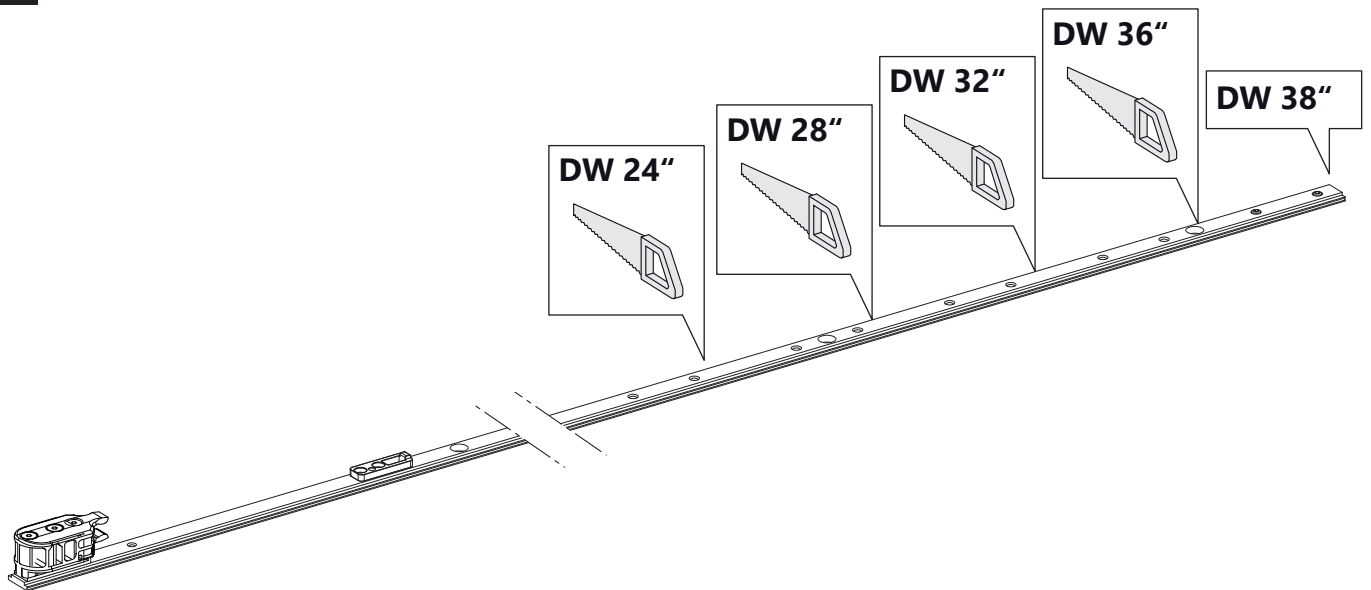

Version 2

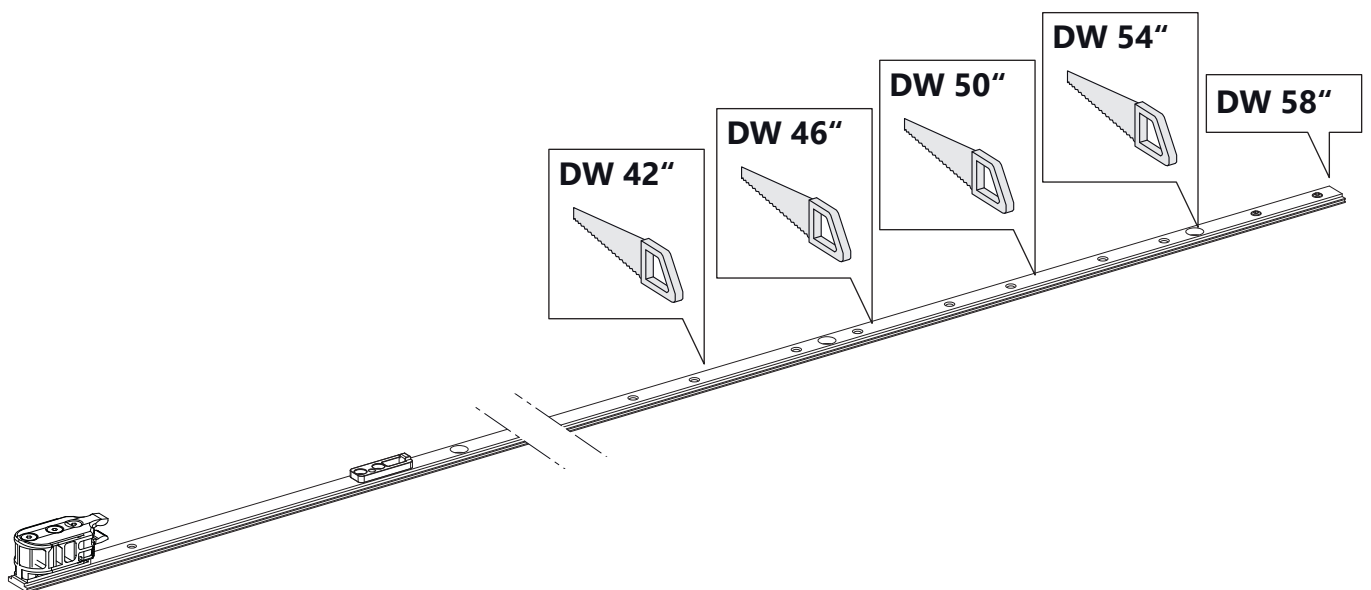

When using a softclose, synchro or push to open, consult the separately enclosed installation instructions.

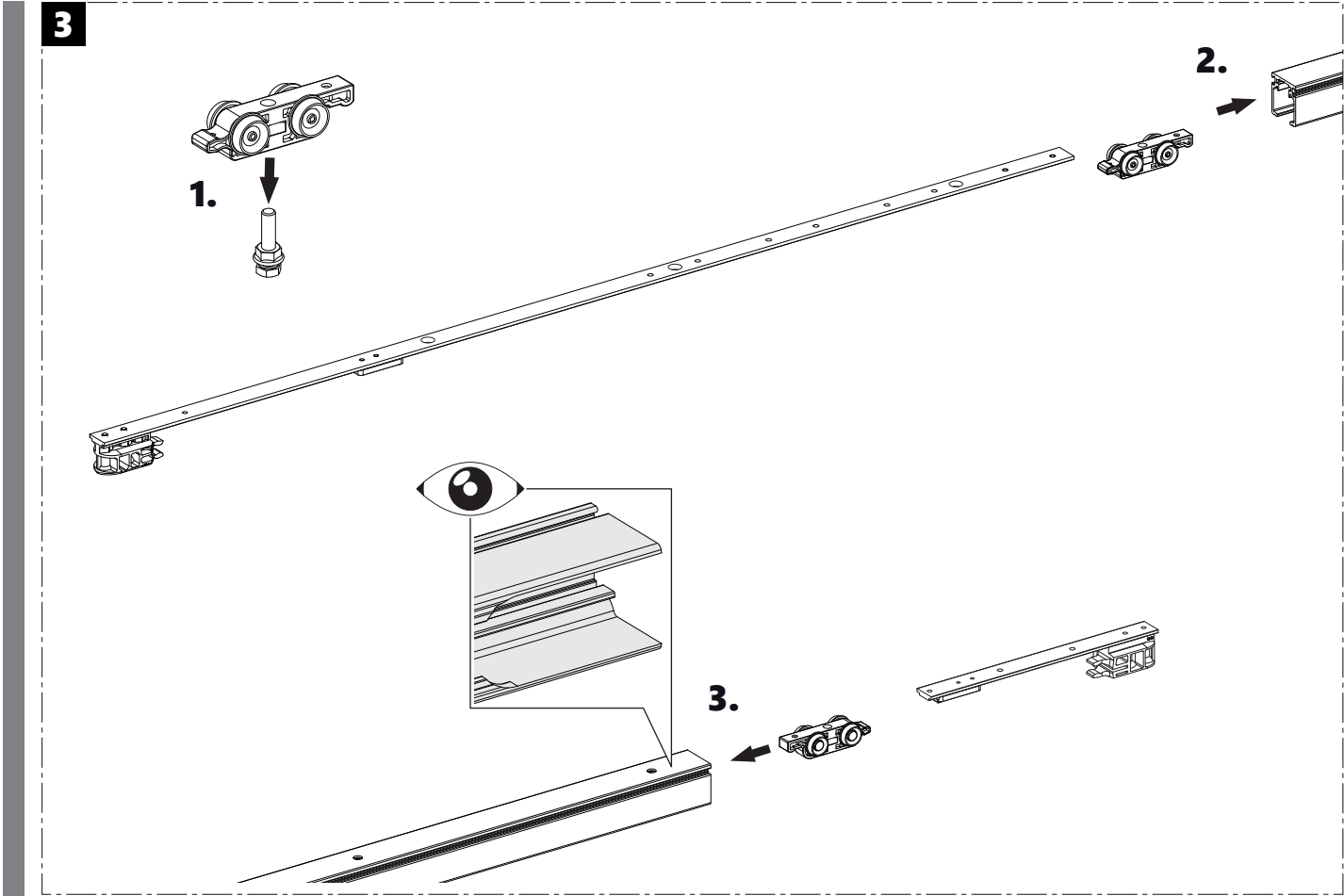

4

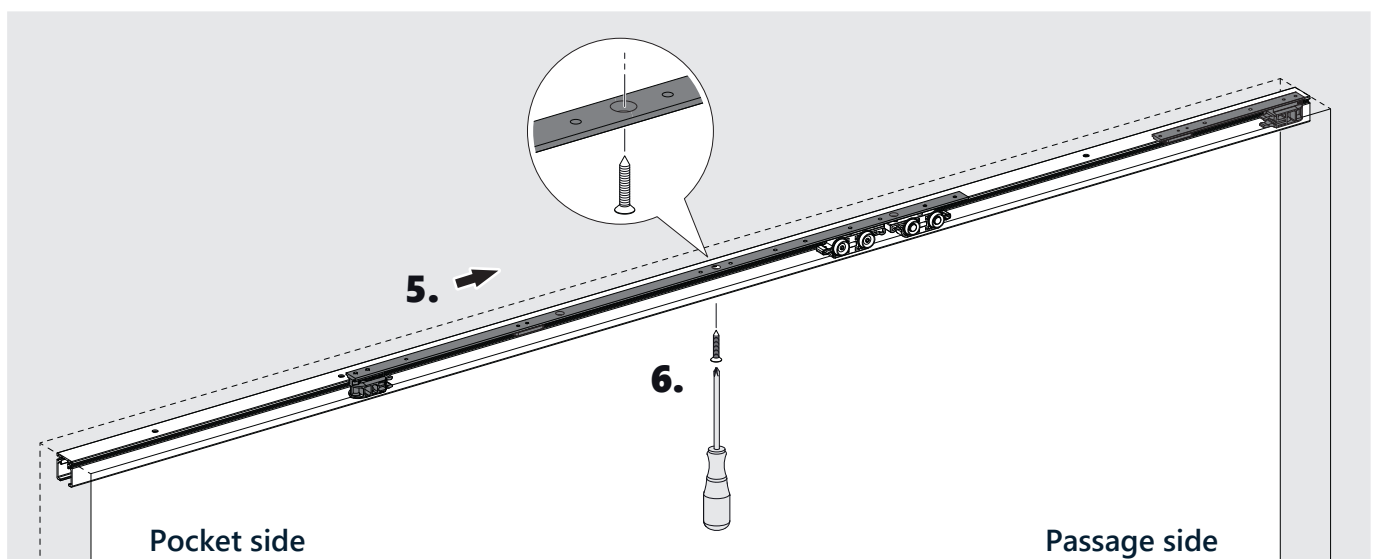
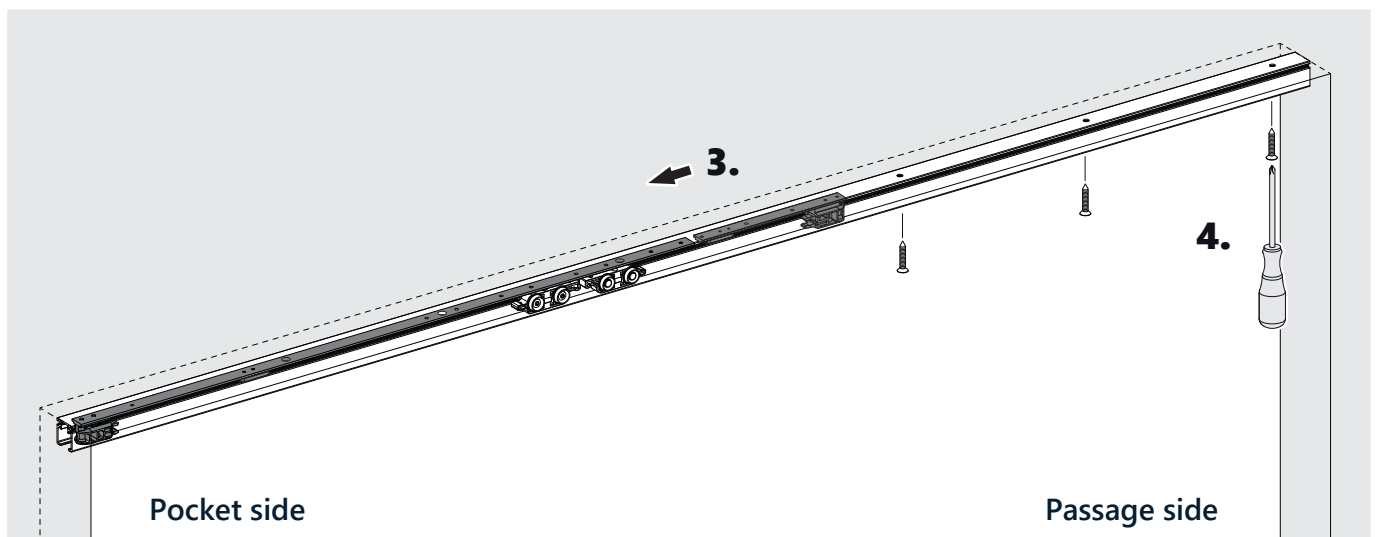
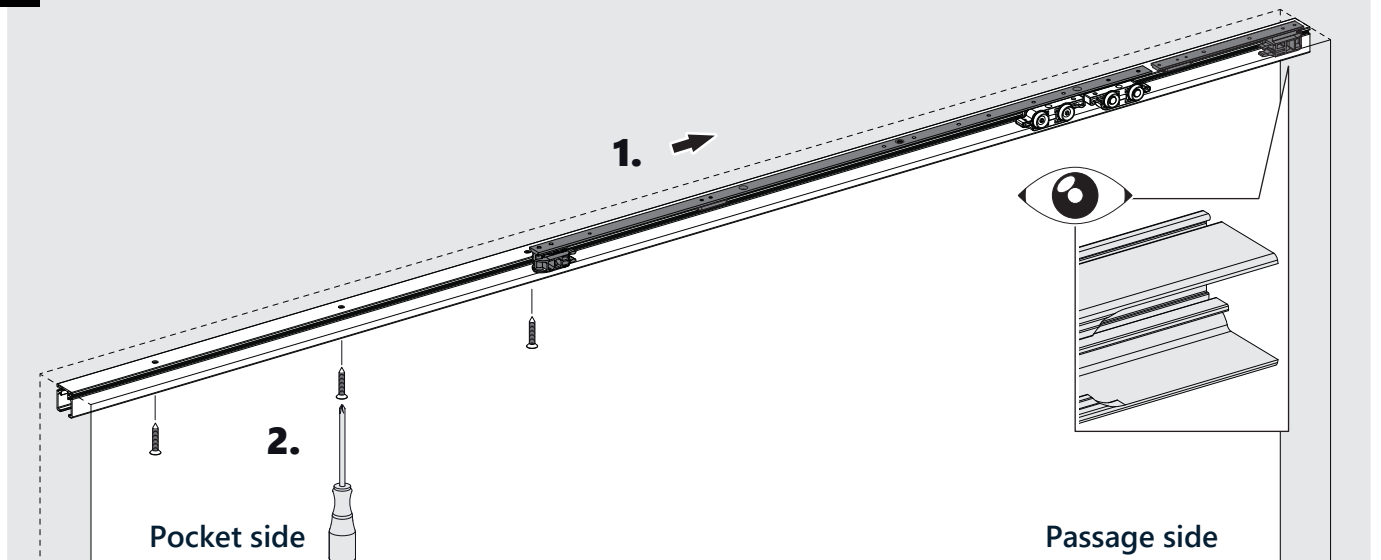

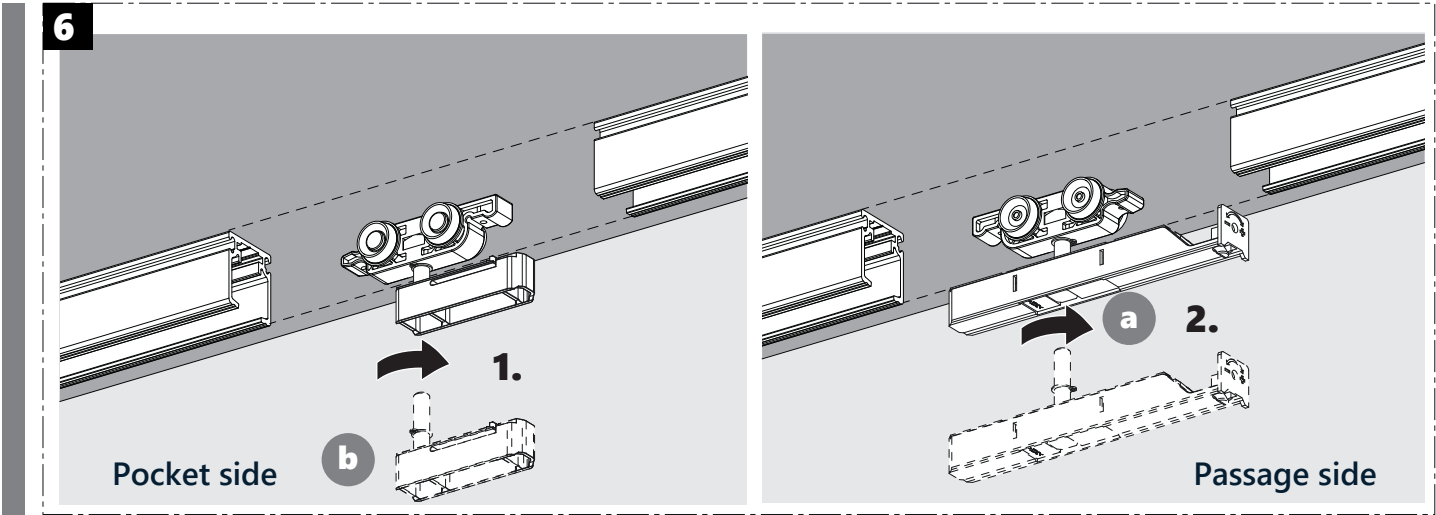
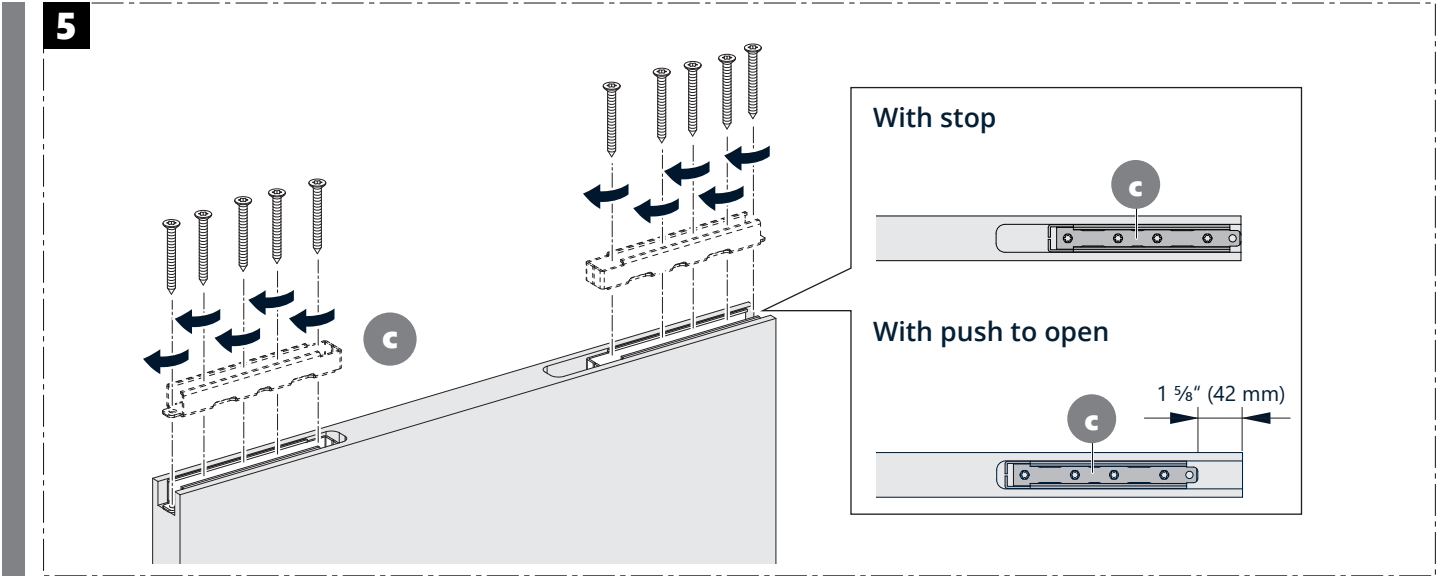

**7**

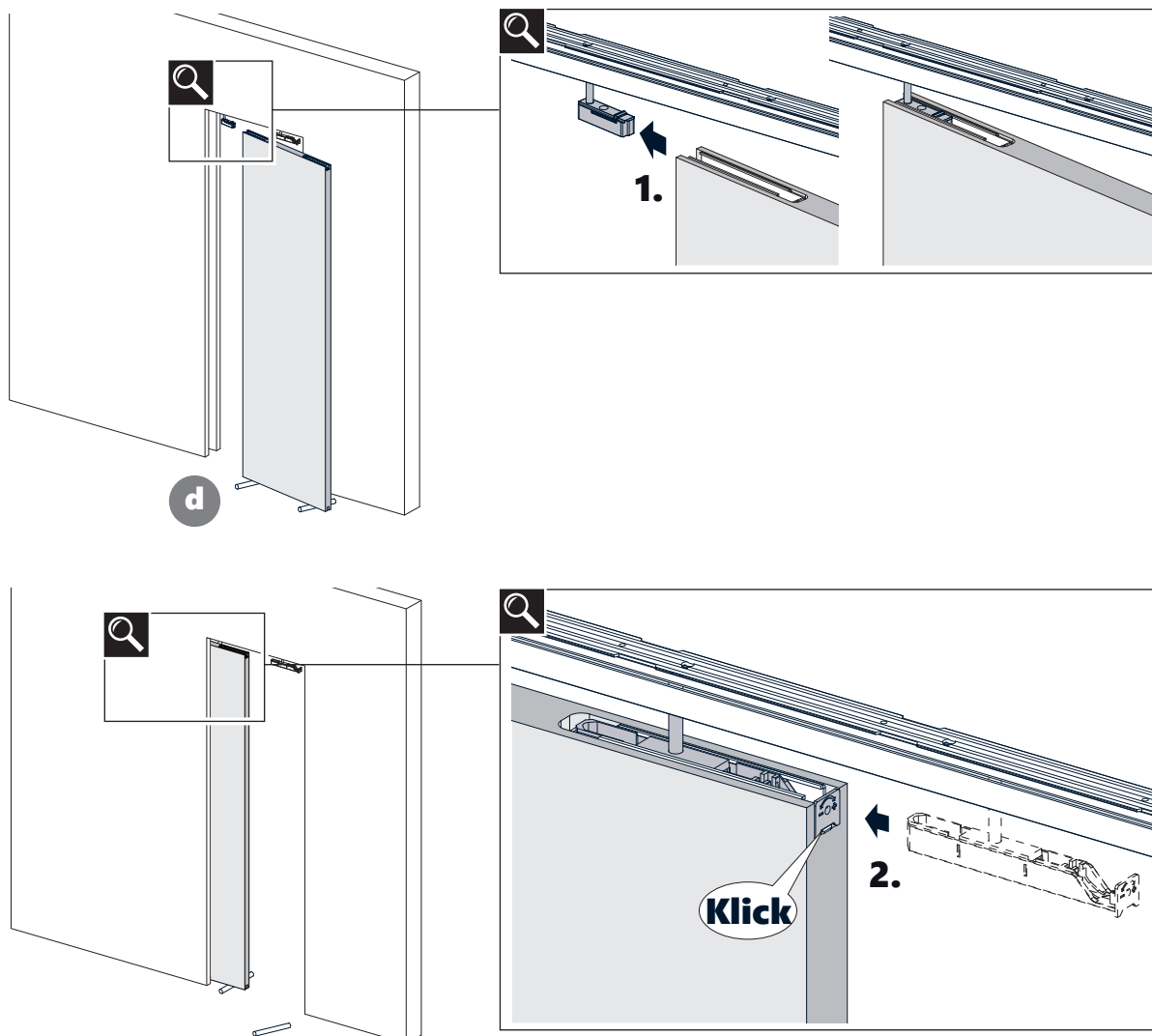

8

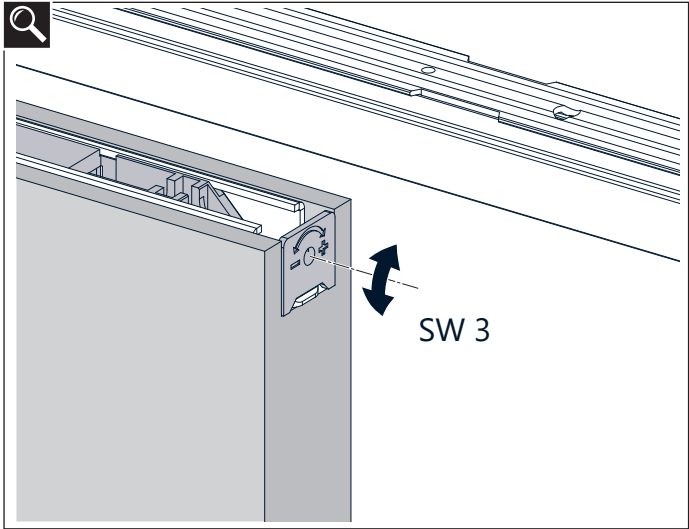
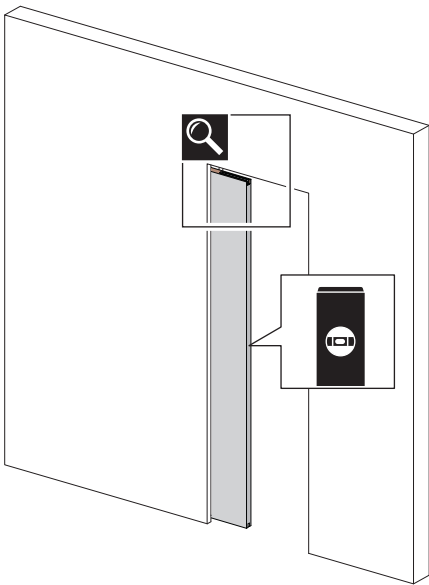

9

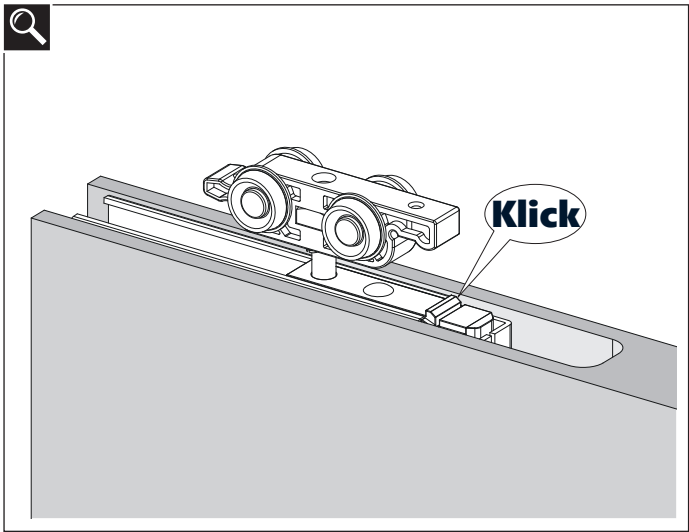
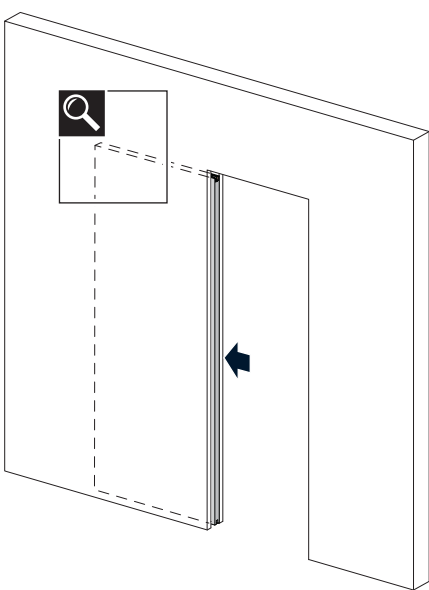

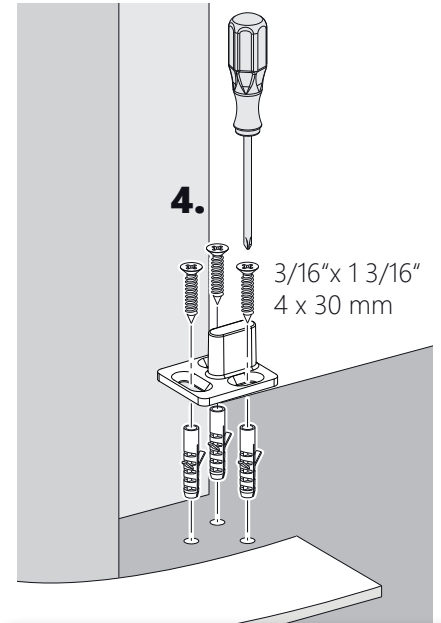
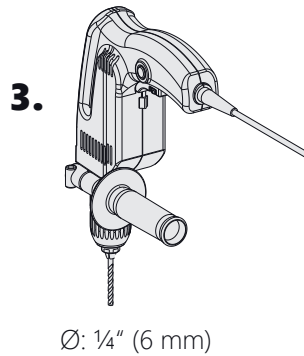
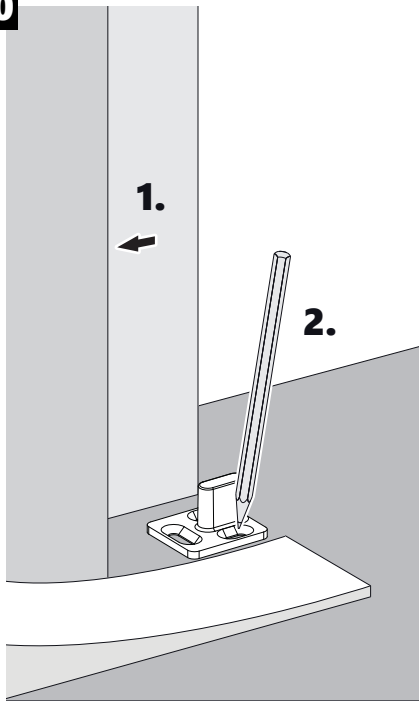

**10**

The fastening material must be provided by the customer and must be adapted to the local conditions!

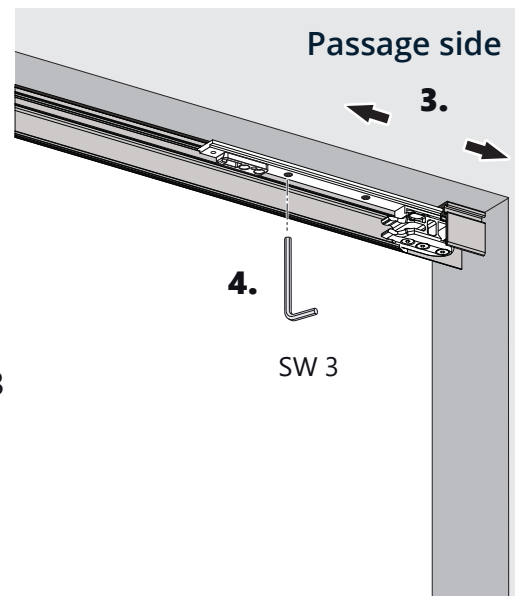
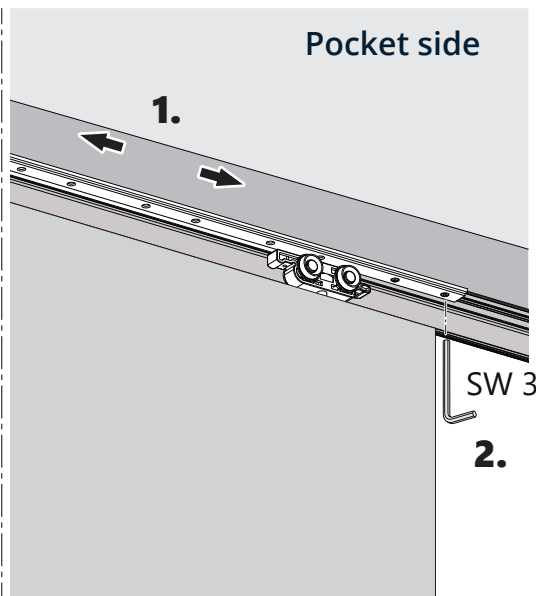
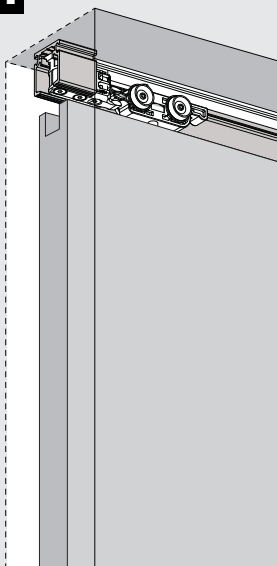
**11**

## Disassembly

