

FALKENSTEIN

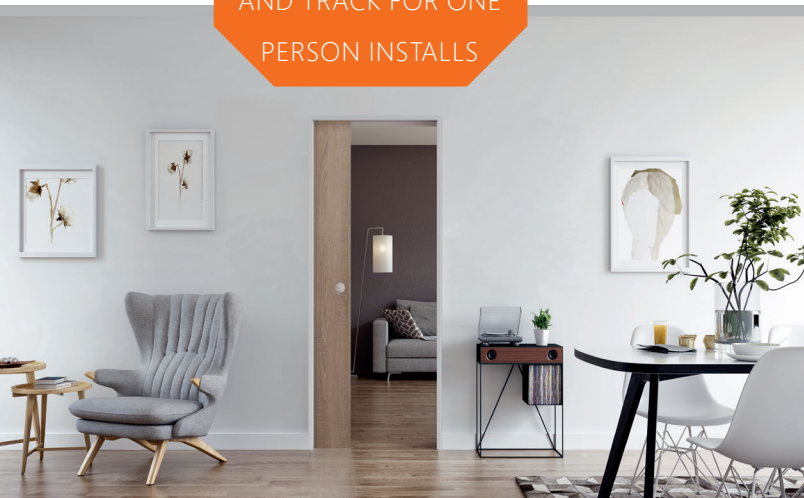

**QUICK AND
VERSATILE**

ADJUSTABLE FRAME
AND TRACK FOR ONE
PERSON INSTALLS



VARIOpocket

Pocket door track and framing kit

SKUS AND ACCESSORIES



Door thickness: 1-3/8" to 1-3/4" wood; 3/8" and 1/2" frameless glass
Studwork: 2x4 wood or 3 5/8" metal
Load capacity: 176 to 265 lb
Set includes: Extruded aluminum track; ball bearing carriages; hold-in-place, soft-close or push-to-open end stops; basic or recessed mounting hardware for wood or clamps for frameless glass panels; floor guides for either application; pocket framing kit made from extruded aluminum; compression clamps

Track and hardware

- 0080801 VARIOpocket 40x96", adjustable up to 40x96" door size, with basic wood hardware, 176 lb
- 0080802 VARIOpocket 48x96", adjustable up to 48x96" door size, with basic wood hardware, 176 lb

Door mounts

- 0080804 Glass Clamps with stainless steel look valance, max. 265 lb, 3/8" and 1/2" glass
- 0080809 Recessed Wood Door Mount, max. 265 lb

Accessories

- 0080805 Soft Close (single), max. 176 lb, min. 24" door width
- 0080806 Soft Close (double), max. 176 lb, min. 34" door width
- 0080807 Push To Open, max. 176 lb, min. 24" door width (26" with pocket side Soft Close)
- 0080808 Sync, for biparting wood doors (basic mount only), max. 176 lb per panel
- 0080810 Upgraded Wheels, max. 265 lb

ROUGH OPENING GUIDE

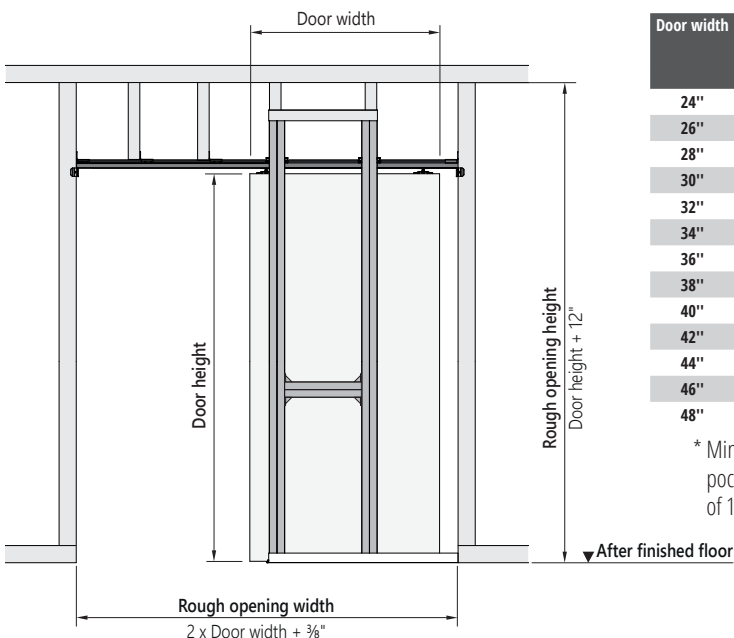

Door width	Door height							
	80"		82"		84"		96"	
	RO width	RO height	RO width	RO height	RO width	RO height	RO width	RO height
24"	48 3/8"	92"*	48 3/8"	94"*	48 3/8"	96"*	48 3/8"	108"
26"	52 3/8"	92"*	52 3/8"	94"*	52 3/8"	96"*	52 3/8"	108"
28"	56 3/8"	92"*	56 3/8"	94"*	56 3/8"	96"*	56 3/8"	108"
30"	60 3/8"	92"*	60 3/8"	94"*	60 3/8"	96"*	60 3/8"	108"
32"	64 3/8"	92"*	64 3/8"	94"*	64 3/8"	96"*	64 3/8"	108"
34"	68 3/8"	92"*	68 3/8"	94"*	68 3/8"	96"*	68 3/8"	108"
36"	72 3/8"	92"*	72 3/8"	94"*	72 3/8"	96"*	72 3/8"	108"
38"	76 3/8"	92"*	76 3/8"	94"*	76 3/8"	96"*	76 3/8"	108"
40"	80 3/8"	92"*	80 3/8"	94"*	80 3/8"	96"*	80 3/8"	108"
42"	84 3/8"	92"*	84 3/8"	94"*	84 3/8"	96"*	84 3/8"	108"
44"	88 3/8"	92"*	88 3/8"	94"*	88 3/8"	96"*	88 3/8"	108"
46"	92 3/8"	92"*	92 3/8"	94"*	92 3/8"	96"*	92 3/8"	108"
48"	96 3/8"	92"*	96 3/8"	94"*	96 3/8"	96"*	96 3/8"	108"

* Minimum required rough opening height. If you have enough headroom, you can install the pocket door without cutting the vertical pocket profiles. This requires a rough opening height of 108" or more.

ROUGH OPENING GUIDE - BIPARTING DOORS

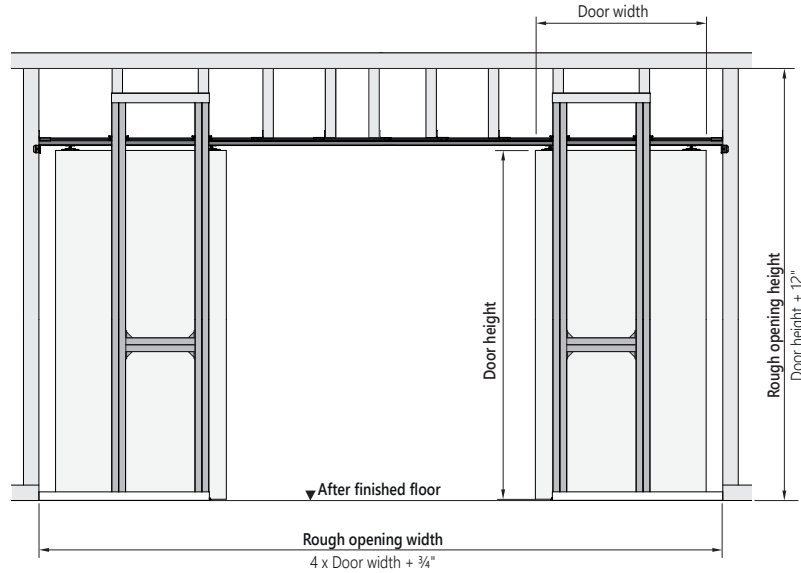

Door width	Door height							
	80"		82"		84"		96"	
	RO width	RO height	RO width	RO height	RO width	RO height	RO width	RO height
24"	96 3/4"	92"*	96 3/4"	94"*	96 3/4"	96"*	96 3/4"	108"
26"	104 3/4"	92"*	104 3/4"	94"*	104 3/4"	96"*	104 3/4"	108"
28"	112 3/4"	92"*	112 3/4"	94"*	112 3/4"	96"*	112 3/4"	108"
30"	120 3/4"	92"*	120 3/4"	94"*	120 3/4"	96"*	120 3/4"	108"
32"	128 3/4"	92"*	128 3/4"	94"*	128 3/4"	96"*	128 3/4"	108"
34"	136 3/4"	92"*	136 3/4"	94"*	136 3/4"	96"*	136 3/4"	108"
36"	144 3/4"	92"*	144 3/4"	94"*	144 3/4"	96"*	144 3/4"	108"
38"	152 3/4"	92"*	152 3/4"	94"*	152 3/4"	96"*	152 3/4"	108"
40"	160 3/4"	92"*	160 3/4"	94"*	160 3/4"	96"*	160 3/4"	108"
42"	168 3/4"	92"*	168 3/4"	94"*	168 3/4"	96"*	168 3/4"	108"
44"	176 3/4"	92"*	176 3/4"	94"*	176 3/4"	96"*	176 3/4"	108"
46"	184 3/4"	92"*	184 3/4"	94"*	184 3/4"	96"*	184 3/4"	108"
48"	192 3/4"	92"*	192 3/4"	94"*	192 3/4"	96"*	192 3/4"	108"

* Minimum required rough opening height. If you have enough headroom, you can install the pocket door without cutting the vertical pocket profiles. This requires a rough opening height of 108" or more.

DOOR MOUNT OPTIONS



WOOD BASIC

WOOD RECESSED

GLASS CLAMPS

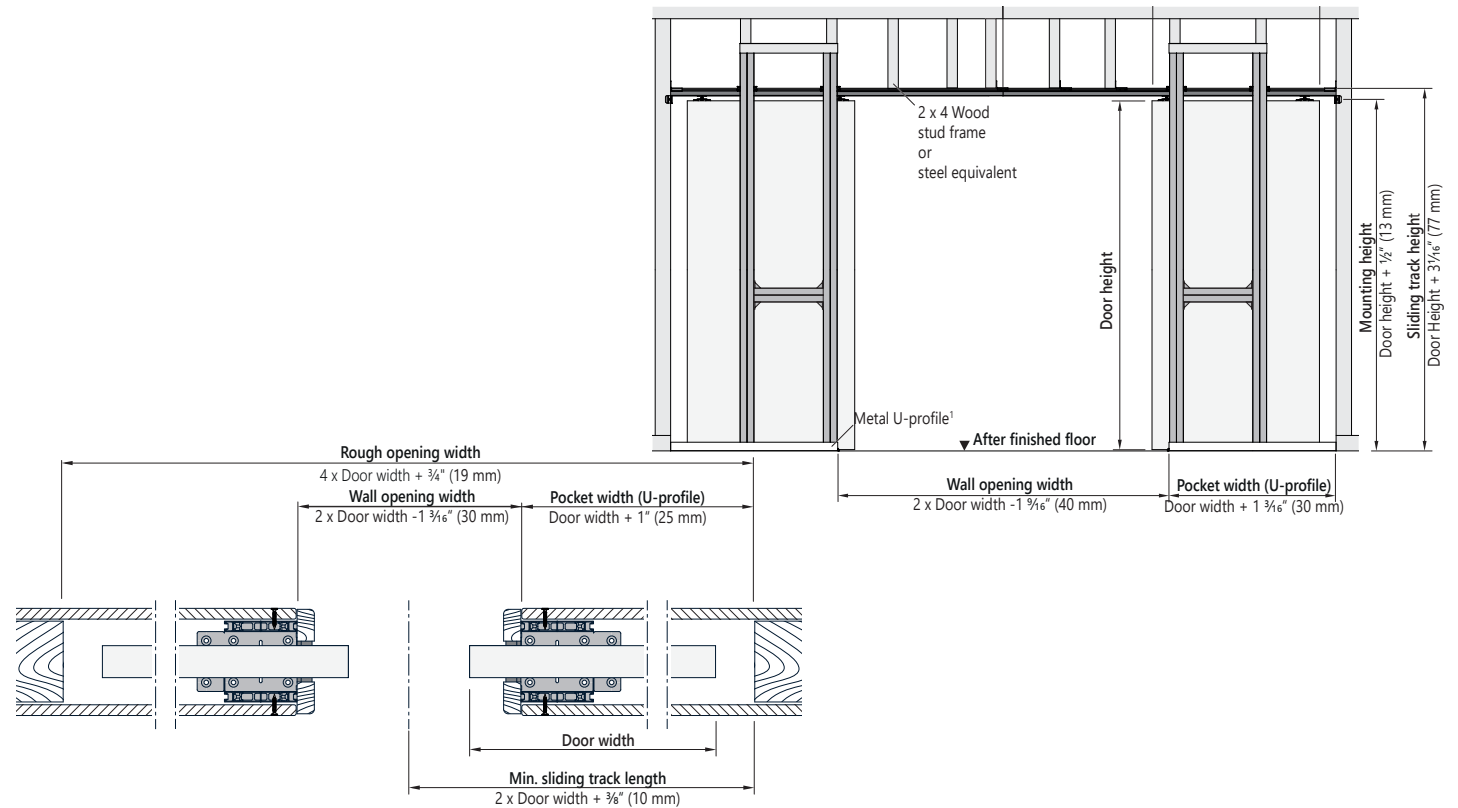
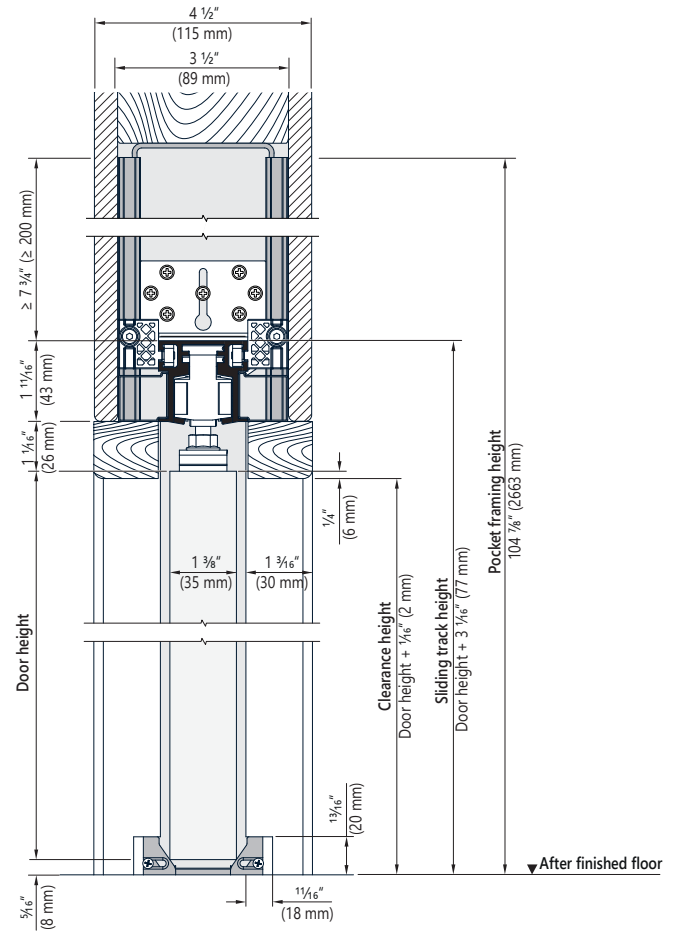
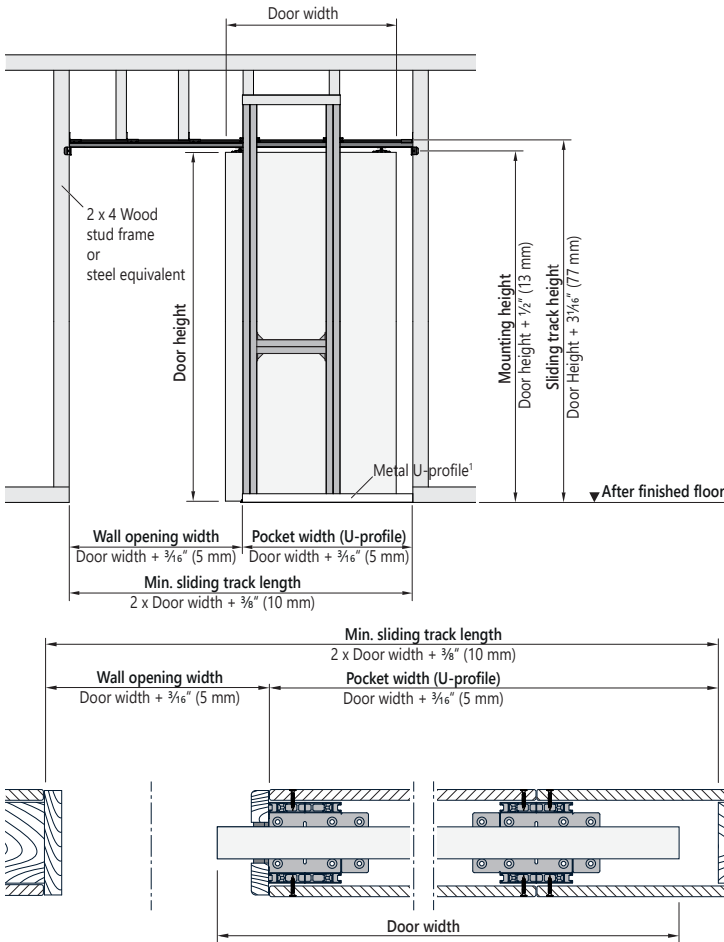

DOOR MOUNT OPTIONS



WOOD BASIC

WOOD RECESSED

GLASS CLAMPS

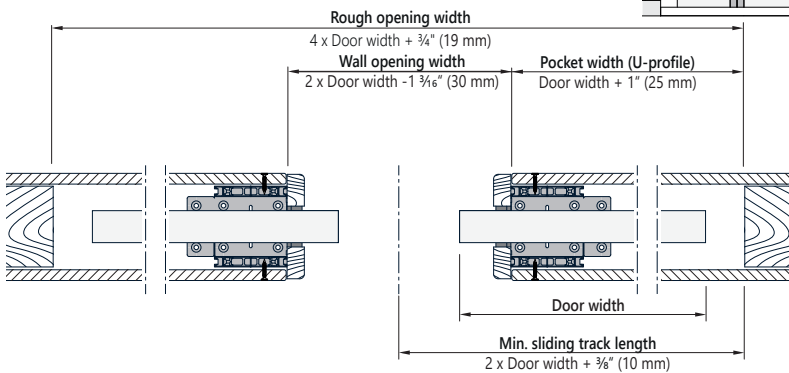
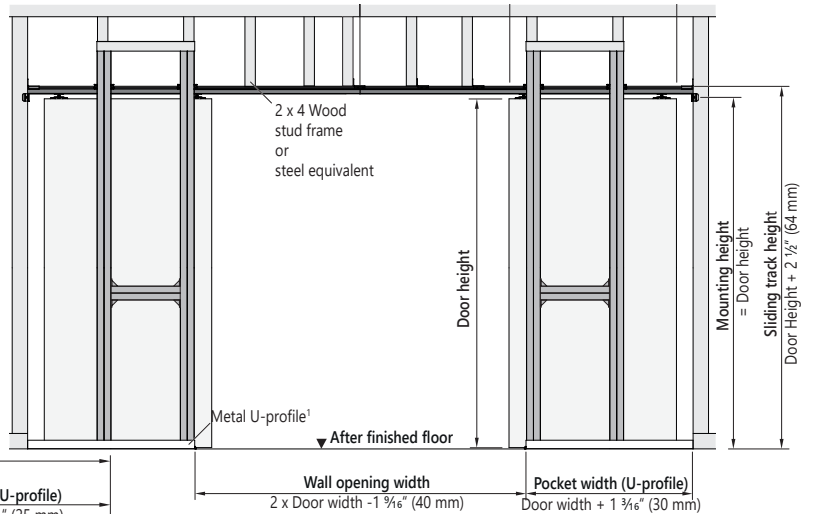
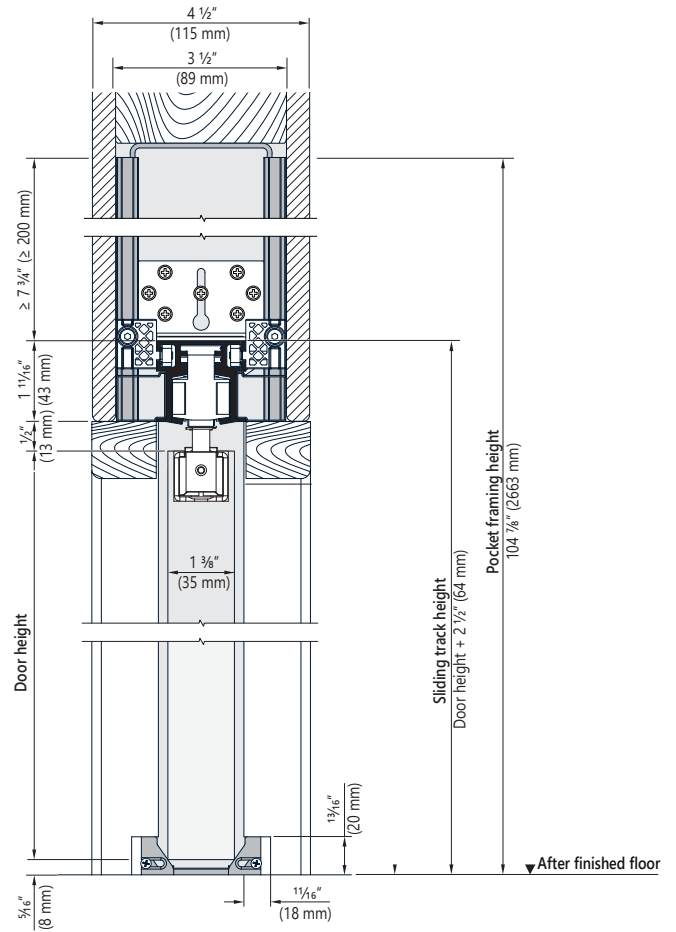
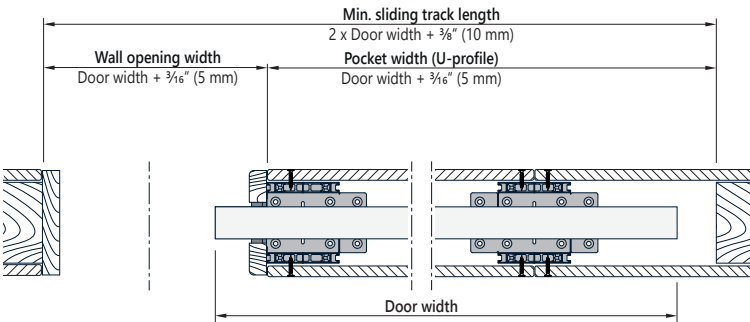
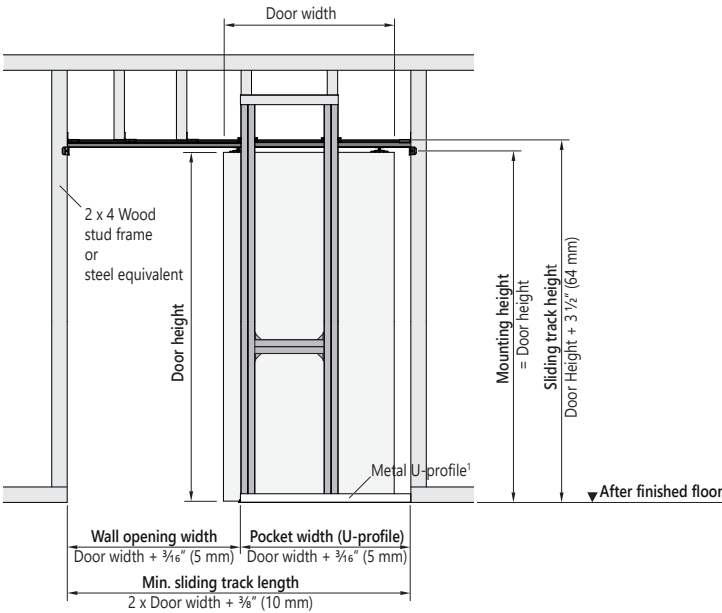

DOOR MOUNT OPTIONS



WOOD BASIC

WOOD RECESSED

GLASS CLAMPS

